

ASSEMBLY INSTRUCTIONS & PARTS LIST

KLOPFENSTEIN *LARGE SIZE* (30X42") TILT TOP ART TABLE (AA300L)

PARTS:

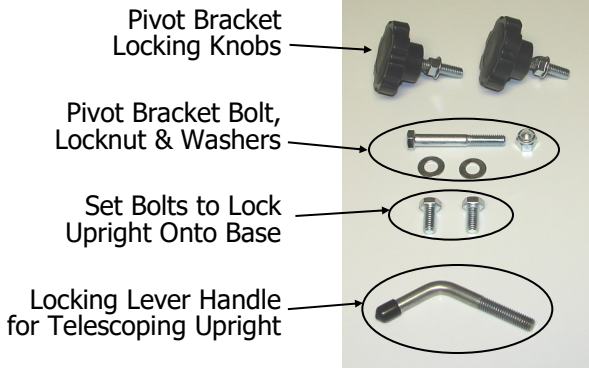

Step 1: Fit base upright onto base as shown.

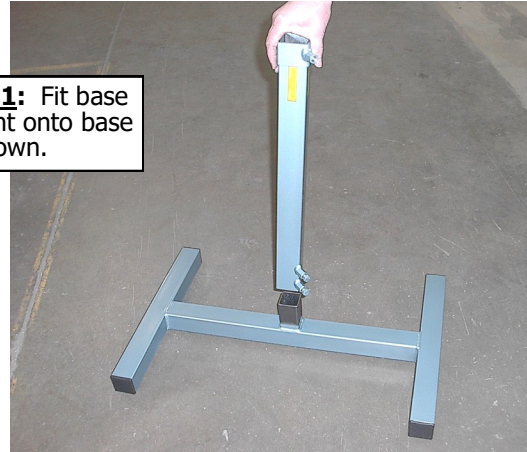

Step 2: Tighten upper then lower bolts back and forth several times until everything is tight, tight!

Your table top is extra large, and heavier than our normal size tops. To compensate for the extra weight we have added an extra half length of spring inside the base upright. The extra half spring and the full spring are already inside the upright.

The full spring is stacked on top of the half spring .

Your springs will work better if you keep them stacked this way.

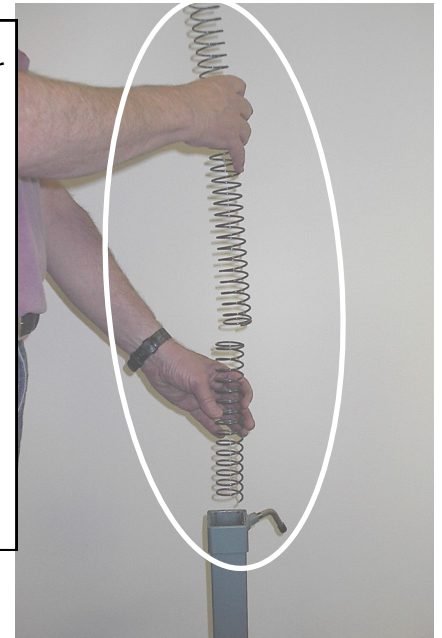

A few inches of the spring will protrude from the top of the upright.

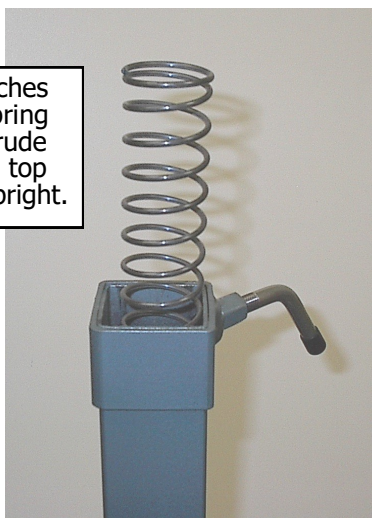

Step 3: Attach the telescoping upright to the pivot bracket & insert it into the assembled base unit.



Adjust height & tilt angle!



Need Help? Call us at 419-884-2900 with questions or comments.

NOTICE:

To keep your Klopfenstein Equipment in proper working order, we recommend all unpainted uprights and extensions be wiped down with a rag or paper towel sprayed with a light oil (like WD40 lubricant) on a monthly bases, or as needed. This is the only maintenance that should be required.