

ASSEMBLY INSTRUCTIONS & PARTS LIST FOR THE KLOPFENSTEIN ART TABLE WITH *OPTIONAL ROTATOR* (AA300L-R)

PARTS:

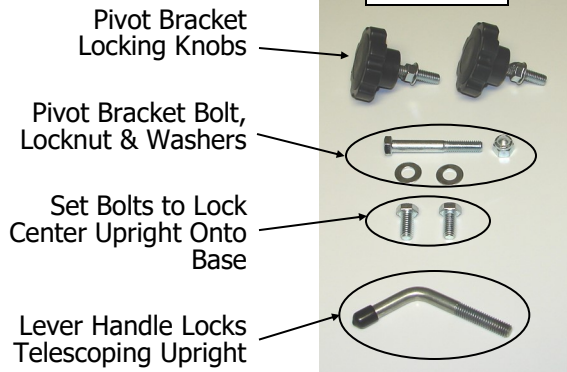

Step 1: Fit Center Upright onto base as shown.

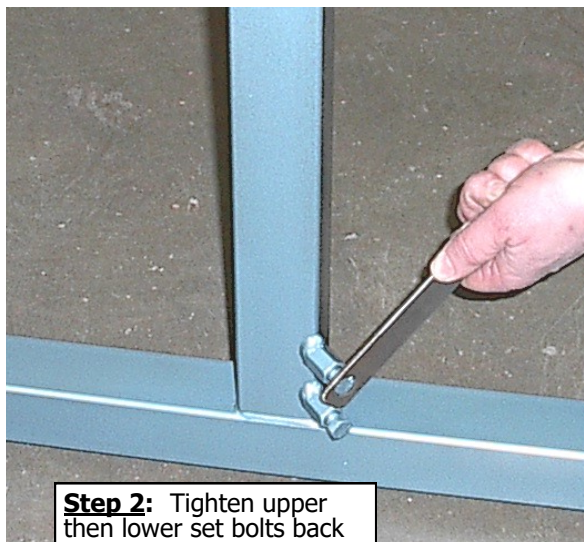
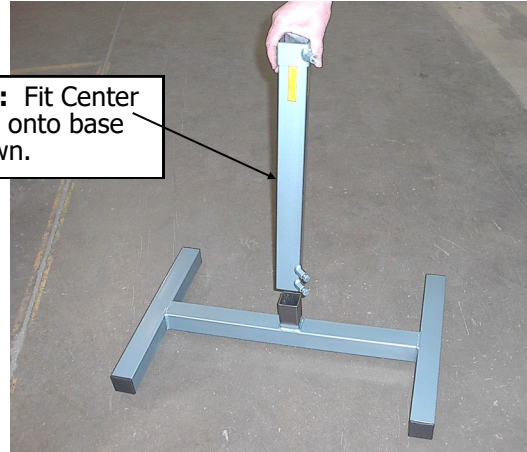

Step 2: Tighten upper then lower set bolts back and forth uniformly until everything is tight, tight!

Your table top with optional rotator is heavier than our normal tops without the rotator. To compensate for the extra weight we have added an extra half length of spring inside the Center Upright. The extra half spring and the full spring are already inside the upright.

The full spring is stacked on top of the half spring with the factory finished end of the half spring up and the cut off end down.

Your springs will work better if you keep them stacked this way.

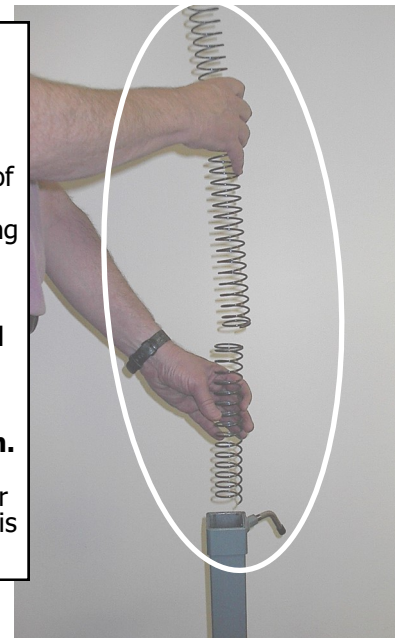

Step 3: Attach the telescoping upright to the pivot bracket with the pivot bracket bolt, washer and locknut. Screw in the pivot bracket locking knobs and insert the upright into the assembled base unit. Screw in lever handle.

Tighten the pivot bracket bolt & nut until there is enough resistance that the top will not unexpectedly fall forward or backward when the locking knobs are loosened to adjust tabletop tilt angle. Do not over tighten, making it difficult to make tilt adjustments.

A few inches of the spring will protrude from the top of the upright.

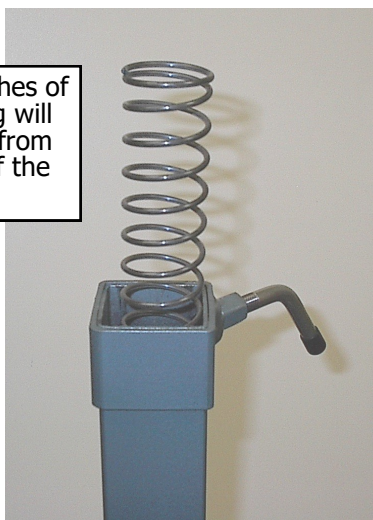

Need Help? Call us at 419-884-2900 with questions or comments.

ADJUSTING THE *OPTIONAL ROTATING* ART TABLE TOP FOR HORIZONTAL OR VERTICAL WORK

Spring loaded steel plunger locks rotating top into a vertical or horizontal orientation. Pull out on plunger knob to rotate top.

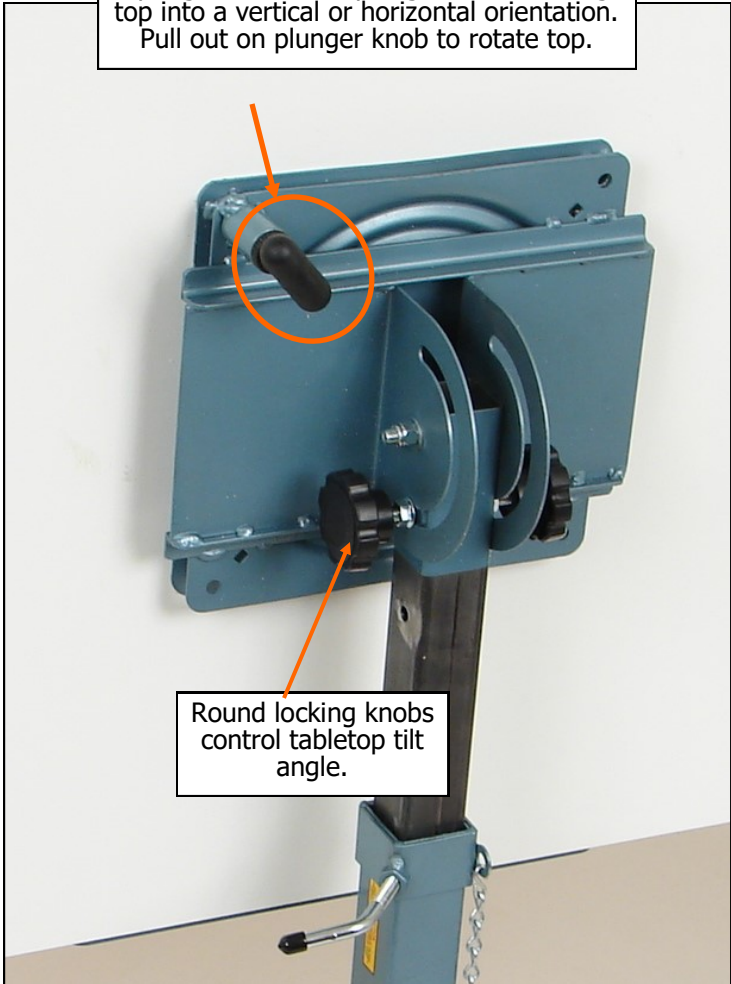

Round locking knobs control tabletop tilt angle.

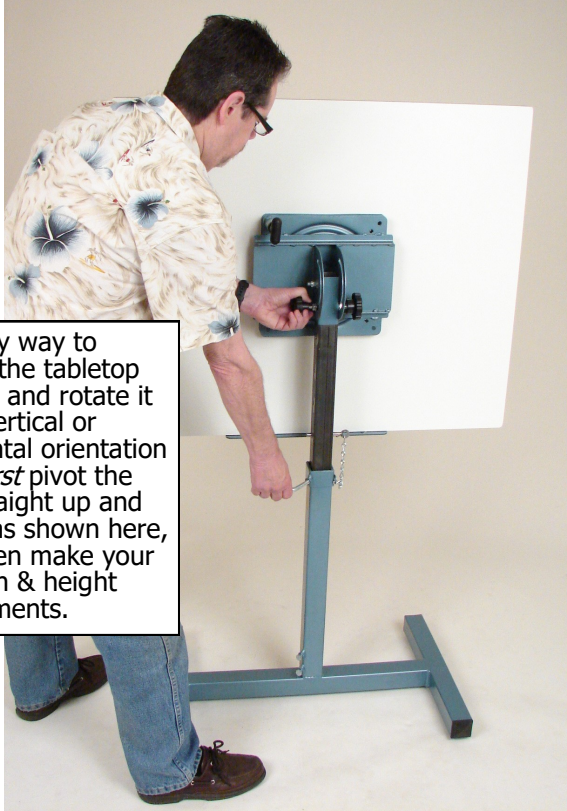

An easy way to adjust the tabletop height, and rotate it to a vertical or horizontal orientation is to *first* pivot the top straight up and down as shown here, and then make your rotation & height adjustments.

Rear View *Vertical* Orientation

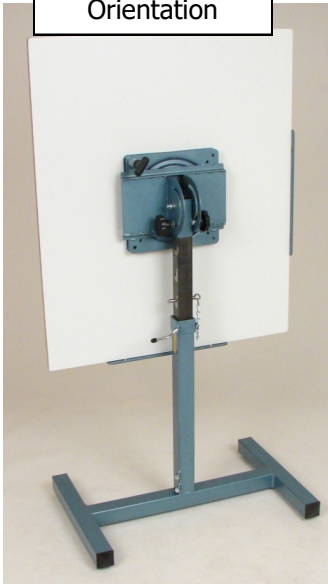

Rear View *Horizontal* Orientation



Top in Horizontal Orientation & Tilted 30° From Vertical



Need Help? Call us at 419-884-2900 with questions or comments.